



Quick Guide

## Konftel 60W Conference Unit

UK English

Conference phones for every situation



For further information, please consult the manual on enclosed CD

## DESCRIPTION

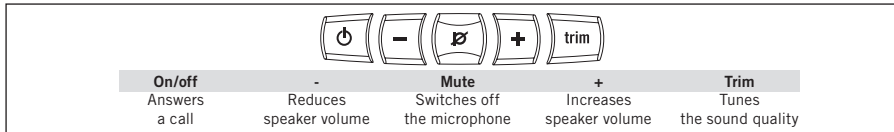
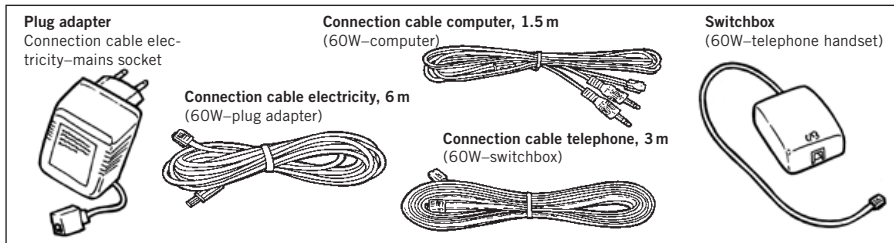
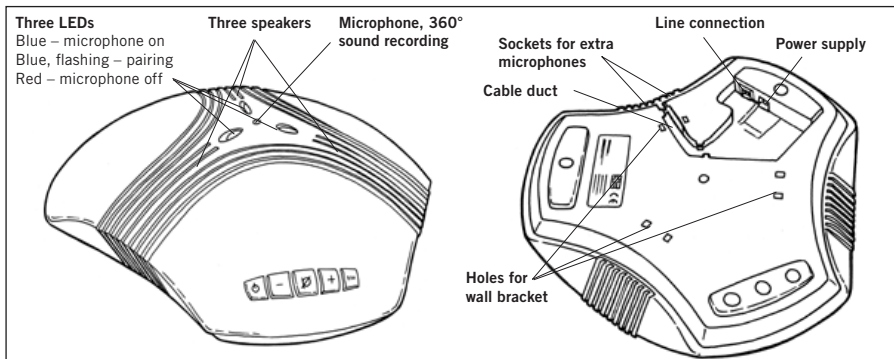

**Konftel 60W** converts a system, DECT or mobile telephone into a conference telephone using OmniSound®, Konftel's unique technology for optimal sound quality. The connection between the telephone and Konftel 60W can be wireless via Bluetooth®. Konftel 60W can also be connected to a computer and accessed using communication software, e.g. Skype®. The user guide and Konftel's website [www.konftel.com](http://www.konftel.com) offer suggestions for various accessories and applications.

### Adjusting the microphone sensitivity

The microphone volume can be adjusted during the call, but to avoid disturbing the call, it may be best to adjust it during a test call after the telephone has been paired.

- ⇨ Press and hold the **mute** button for 2 seconds until the LEDs start to flash and you hear a tone.
- or ⇨ Increase the microphone volume using **+** and reduce it using **-**.  
Adjust the microphone volume one level at a time until you can hear well in the other end. Please note that too high a level may cause echoes and feedback.
- ⇨ Press the **mute** button to conclude setting the selected microphone volume.

# WIRELESS CONNECTION TO TELEPHONE VIA BLUETOOTH

## Connecting

Bluetooth has a range of up to ten metres. Optimum performance is achieved when the distance does not exceed five metres.

- ⇒ Plug Konftel 60W in using the power adapter as shown in the picture.

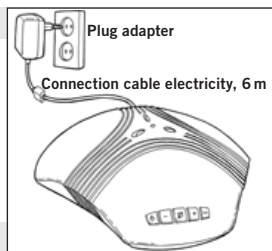

## Adding a telephone (pairing)

Please note that Konftel 60W must not be switched on.



- ⇒ Press and hold the **trim** button for 2 seconds until the blue indicator lights start to flash.



- ⇒ Follow the instructions in your telephone handbook to add a new Bluetooth unit to your telephone.
- ⇒ Select **Konftel 60W** in the list of units detected.
- ⇒ Enter the password **0000**.

If the pairing was successful, a short audible signal will be heard and the LEDs will stop flashing. If the pairing does not work, repeat the steps above but press and hold **trim** button for 4 seconds instead of 2. The blue LEDs then start flashing more slowly.

## Answering a call



- ⇒ Press the **on/off** button when Konftel 60W rings (the LEDs flash).

## Making a call



- ⇒ Make a call with your telephone in the normal way.
- ⇒ Transfer the call to Konftel 60W as per the instructions in the telephone handbook.

## Transferring a call between Konftel 60W and a telephone



- ⇒ Press and hold the **on/off** button for 2 seconds to transfer the call back to your phone.

## Ending a call



- ⇒ Ending the call on your telephone.  
Konftel 60W switches off automatically.

## Disconnecting the Bluetooth link

If you do not intend to use the phone for a while, you can choose to disconnect the link to save power. The link is automatically connected when the telephone rings or you make a call.



- ⇒ Press the **mute** button to disconnect the Bluetooth link.

## CONNECTION TO SYSTEM TELEPHONE USING CABLE

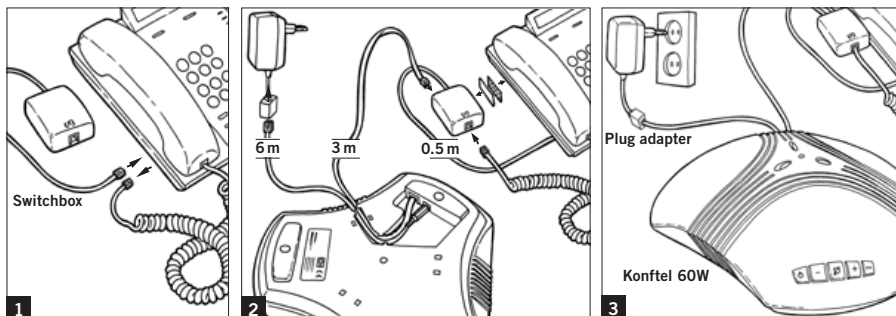

### Connecting

- ⇒ Connect Konftel 60W to the telephone via the switchbox as per the picture above.
- ⇒ Plug Konftel 60W in using the power adapter as shown in the picture.
- ⇒ Make a test call to check that everything works and to adjust the microphone setting.

### Answering a call



- ⇒ Answer the call using the telephone in the normal way.



- ⇒ Press the **on/off** button to switch on Konftel 60W and change to a speaker call. The telephone headset is now disconnected.

### Making a call



- ⇒ Lift the handset and dial the number.



- ⇒ Press the **on/off** button to switch on Konftel 60W and change to a speaker call. The telephone headset is now disconnected.

### Transferring a call between Konftel 60W and a telephone



- ⇒ Press the **on/off** button to switch off Konftel 60W and transfer the call back to the telephone.

### Adjusting the speaker volume

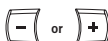

- ⇒ Increase the speaker volume using + and reduce it using -.

### Ending a call



- ⇒ Hang up the handset.



- ⇒ Press the **on/off** button to switch off Konftel 60W.

## CONNECTION TO COMPUTER USING CABLE

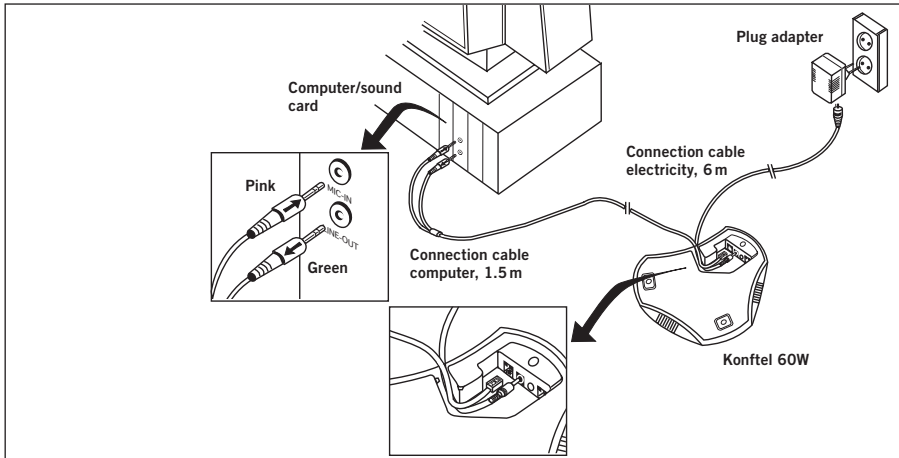

### Connecting

Konftel 60W functions as a speaker and microphone for all PCs. It can be connected using a cable to the computer's soundcard, via a USB adapter (accessory) or via a Bluetooth adapter (accessory). See the handbook for more information on the last two connection methods.

Connect in the order specified below.

- ⇒ Connect Konftel 60W to the sound card using the accompanying Y-cable as per the picture.

LINE OUTPUT ----- OUT (Green)  
MICROPHONE INPUT - IN (Pink)

- ⇒ Plug Konftel 60W in using the power adapter as shown in the picture.
- ⇒ Start the computer and switch on Konftel 60W ( **on/off** ).
- ⇒ Check and adjust the computer's sound and volume settings. Please note that you may need to adjust the microphone and speaker volume in both the computer's settings and on Konftel 60W.



### Using Konftel 60W with a computer

You can use Konftel 60W for programs that communicate over the Internet (e.g. Skype). You make, answer and end calls in the program. Konftel 60W functions as a speaker and microphone when it is switched on.

**Konftel** is a leading company within loudspeaker communication and audio technology. We develop and sell products and technology for telephone meetings based on cutting-edge expertise within acoustics and digital signal processing. Characteristic of our products is that all conference telephones contain the same high quality audio technology – OmniSound® – providing crystal clear sound. Learn more about Konftel and our other products on [www.konftel.com](http://www.konftel.com)

Developed by Konftel AB  
Box 268, SE-901 06 Umeå, Sweden  
Phone: +46 90 706 489 Fax: +46 90 131 435  
E-mail: [info@konftel.com](mailto:info@konftel.com) Web: [www.konftel.com](http://www.konftel.com)

---

---